

TECHNICAL SHEET

SUPER 7 GUTTER



DESCRIPTION

The Super 7 gutter is molded and manufactured on site in one single piece to ensure there is no joint between sections. The Super 7 gutter can fit all types of roofs and structures. To avoid any overflow on the building side, the dorsal height of the gutter is higher than the facade height.



APPLICATION

Ideal for roofs with large areas.
The Super 7 gutter is assembled with 100 x 125 mm (4 in x 5 in) downspouts.

INSTALLATION

The Super 7 gutter is fixed with one of the following fixing systems :

- ♦ with specially designed hangers conceived to be fixed to the front crimp of the gutter and to the building fascia.
- ♦ with self-tapping screws fixed through the back of the gutter every 300 mm (12 in) c/c.

MATERIALS

Gutter:

- ♦ Galvanized, GalvalumeMD or prepainted steel of :
 - 22 gauge (0.88 mm or 0.032 in)
 - 24 gauge (0.65 mm or 0.026 in)
- ♦ 20 oz (0.686 mm or 0.027 in) copper

Fixing method:

- ♦ 16 gauge galvanized steel hanger
- ♦ metal strip from the same material as the gutter
- ♦ Self-tapping stainless steel screw with neoprene insert, 14 gauge with solid thread (without shank)

Sealer:

- ♦ recommended sealant or caulk: Tremco Dynamic® or equivalent

TECHNICAL SHEET

SUPER 7 GUTTER

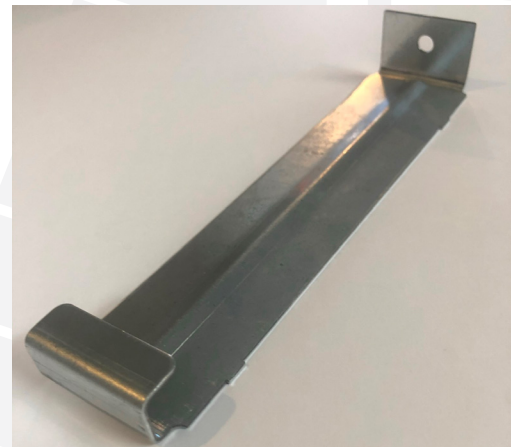
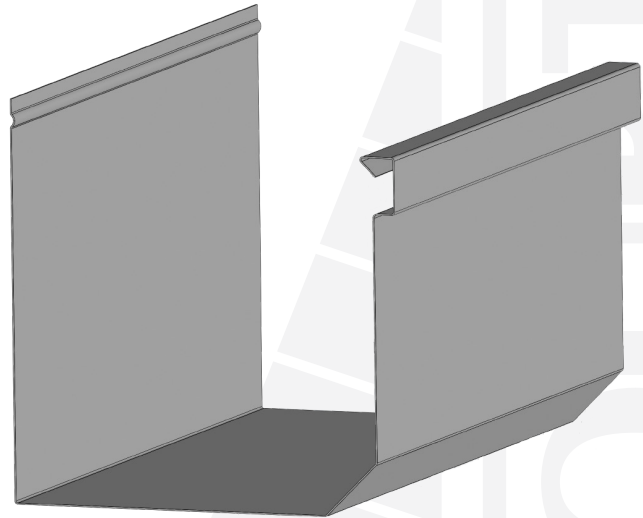
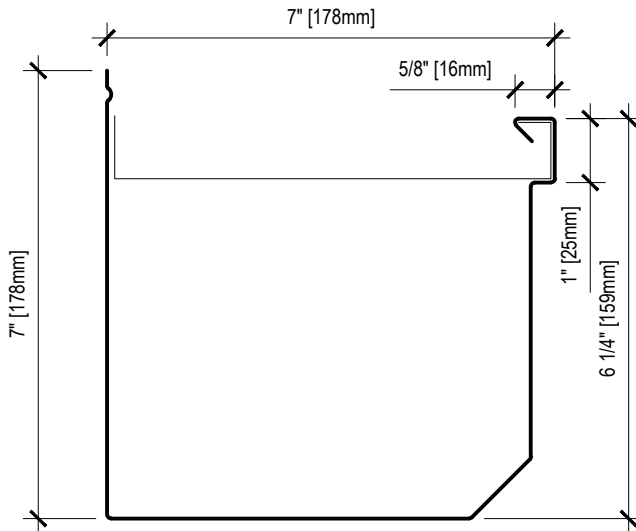

COLOR

Standard color: Pre-painted gutters are offered in standard colors from the Perspectra Plus® charts (Arcelor Mittal Dofasco) or in the CoolR series colors available on the market.

Special color: Please check availability with our Vaillancourt sales team.

GUARANTEE

Installation: 10 years (when installed accordingly to Vaillancourt recommendations)

Materials: 25 years.